

Bedienungsanleitung

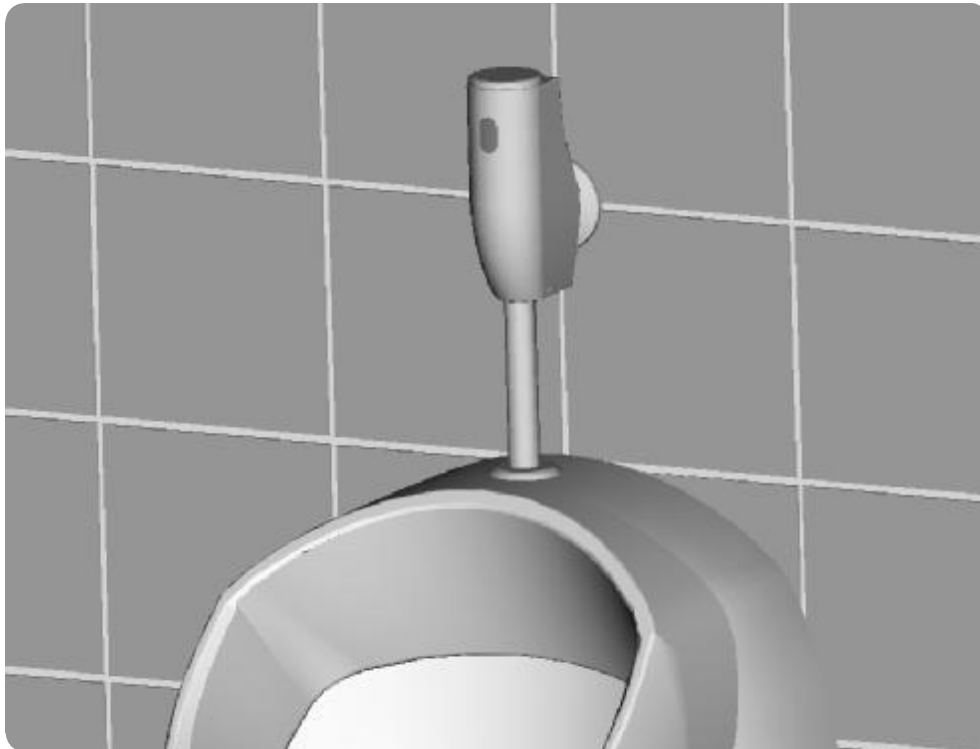

Automatischer Urinal-Spüler

WMU 5100 ECO-Line

6 V =

WATER & MORE Systemzentrale GmbH
Schulstraße 12a

D-51399 Burscheid
Geschäftsführer: Klaus Peters
HRB 57373 Amtsgericht Köln
USt.-Id. Nr. DE247731548
Tel: +49(0)2174-786064
Fax: +49(0)2174-786063

E-Mail: kpeters@water-more.com

Internet: www.water-more.com

1. Technische Daten

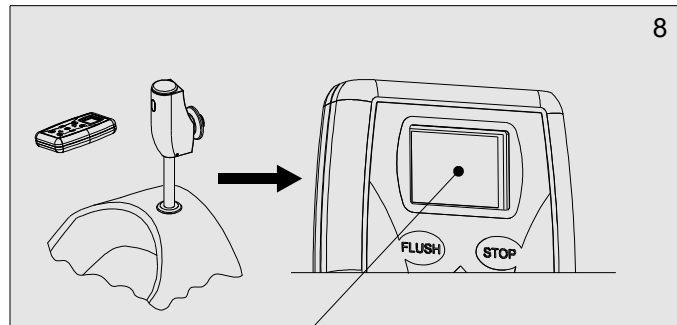
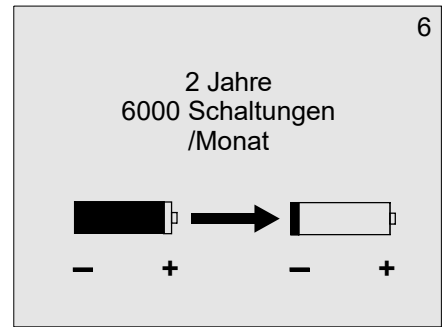
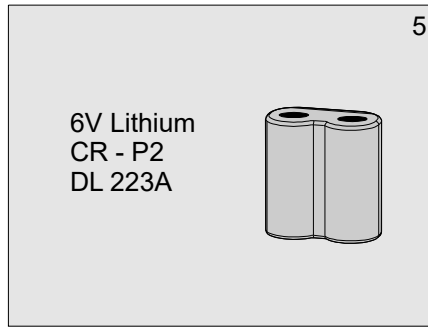
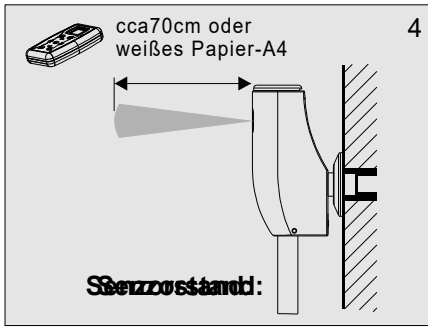
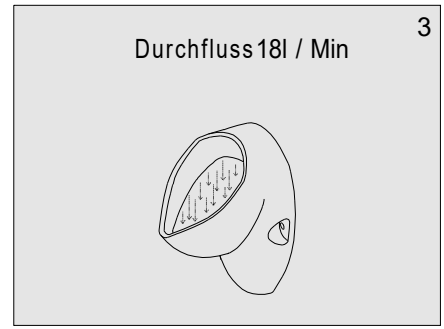
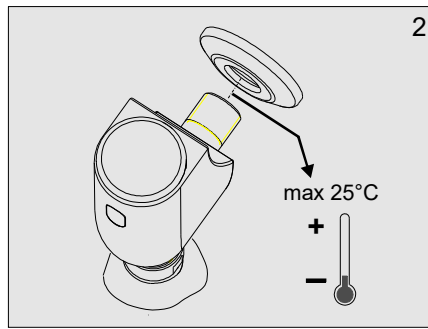
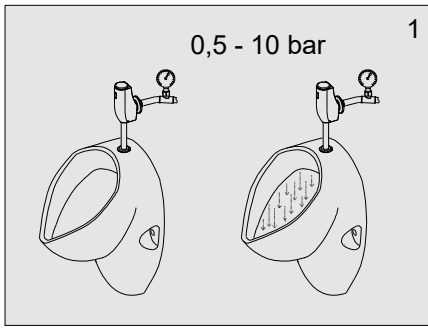

Systeminfo

Hyg. Status

Senzorstand: 9

1. **Sensor Laufzeit**
2. **Anzahl Ventilzyklen**
Benutzerzähler:
Gesamtzahl:
3. **Lange Stoppzeit**
Aktuelle Laufzeit:
Rest Laufzeit:
4. Code Number:
Software ID:

Hyg. Zustand: 10

Soll:
Stagnationszeit:
Einst. vor.:
Hyg.Spülung soll:

2. Funktionsbeschreibung

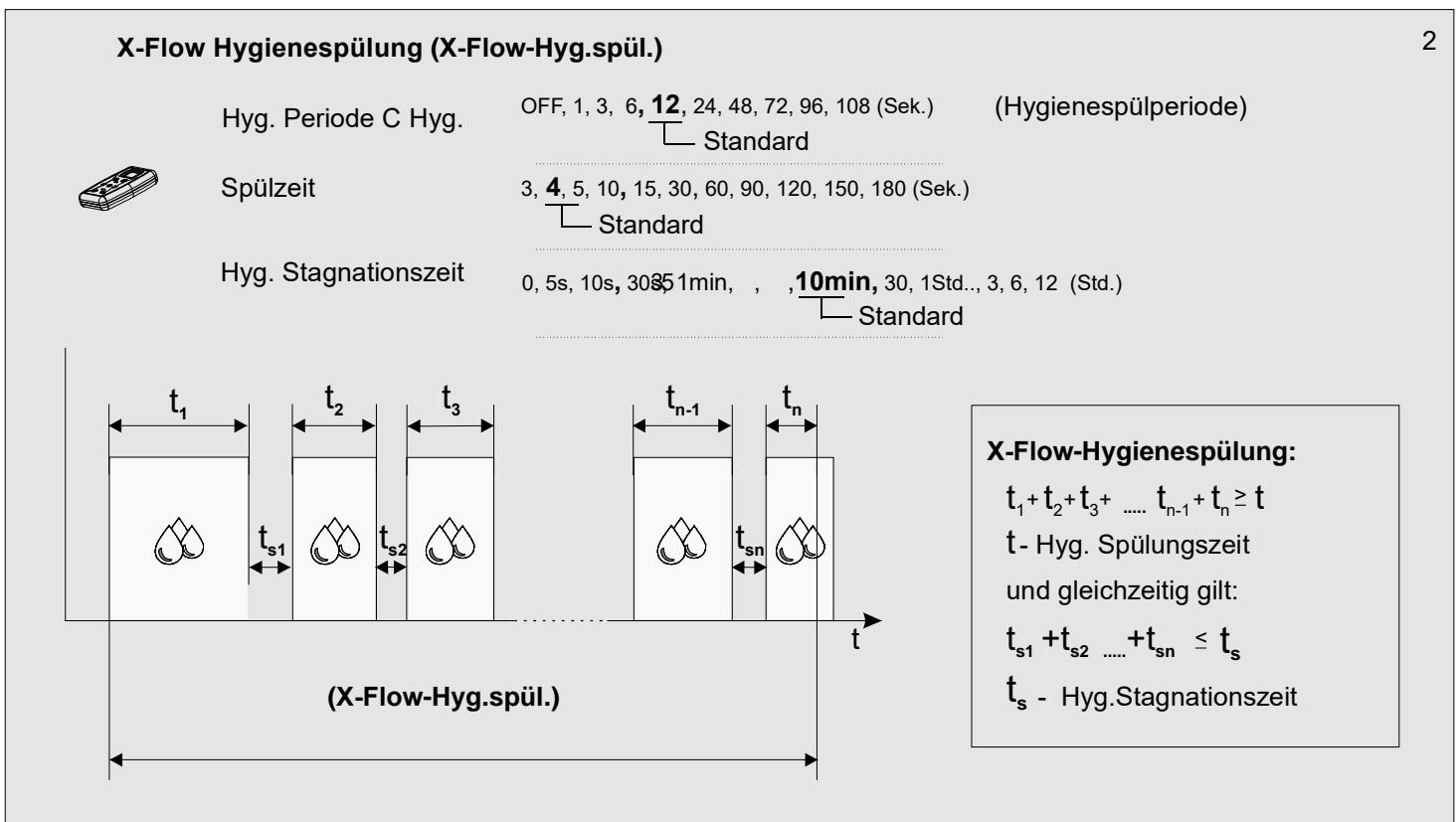
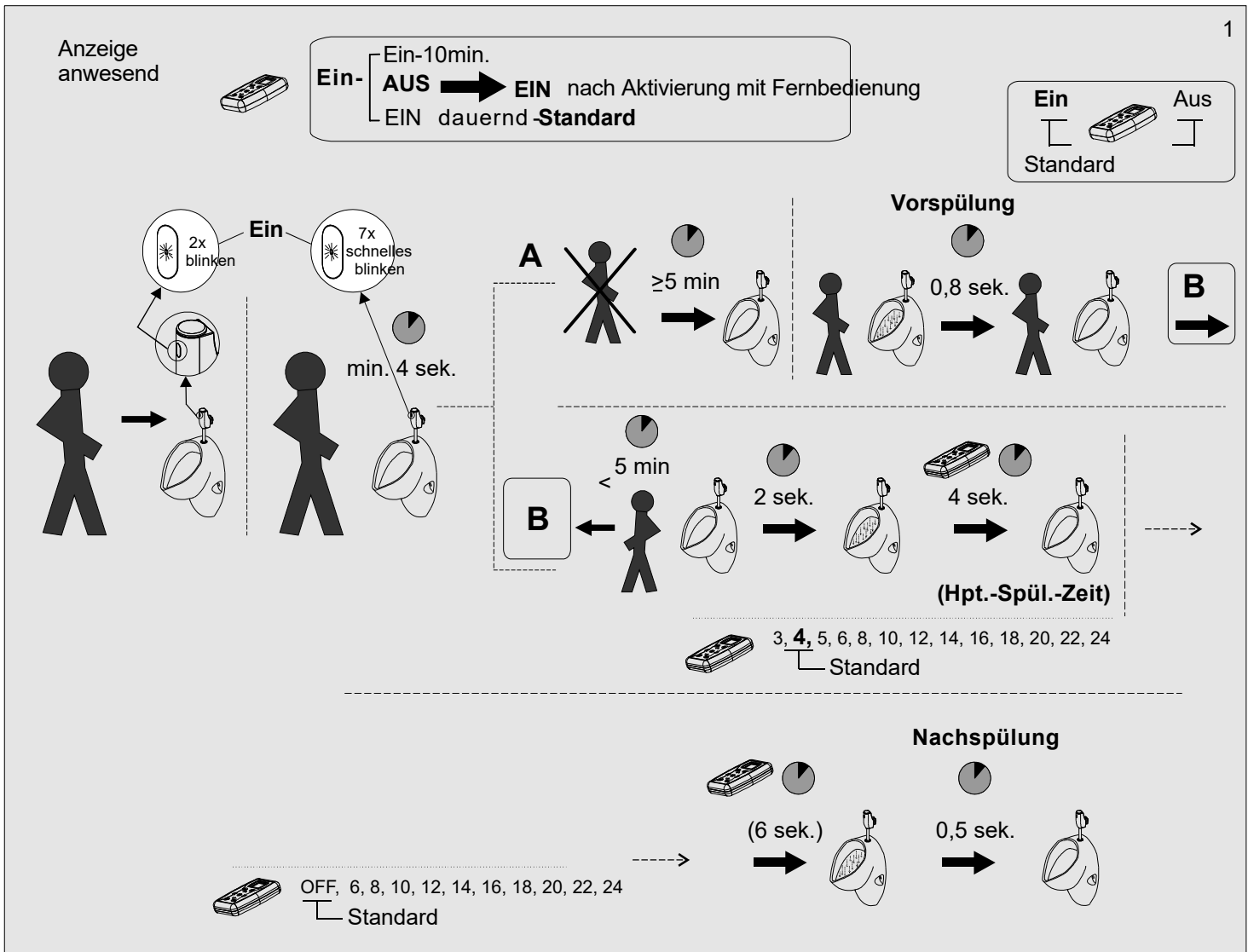

X-Flow Hygienespülperiode

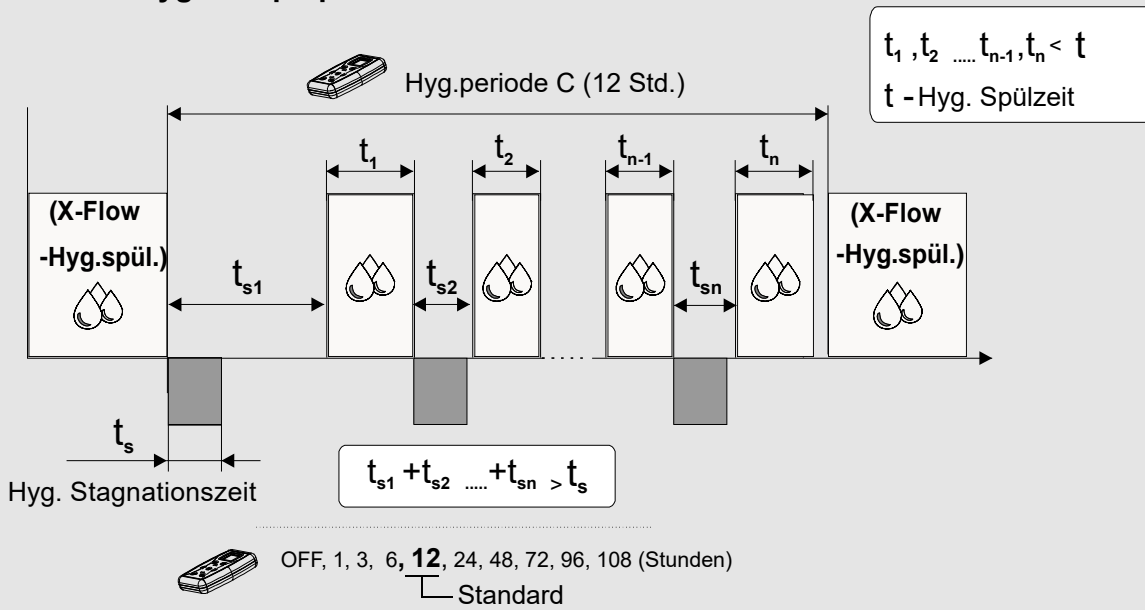

Reinigungsspülung

OFF, 1, 3, 6, 12, 24, 48, 72, 96, 108 (Stunden)
Standard

ohne Spülung

Reinigungsspülung (Aktivierung)

AUS → EIN
(1, 3, 6, 12, 24, 48, 72, 96, 108 Stunden)

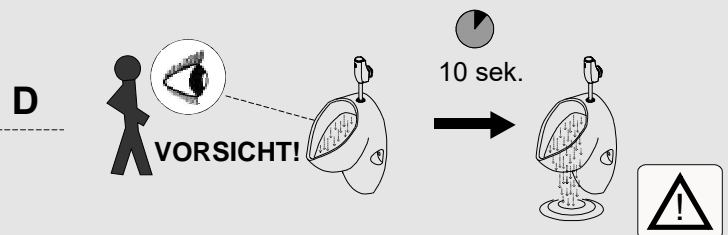
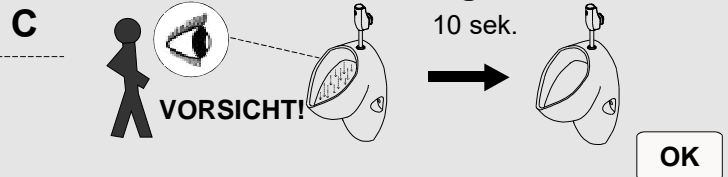
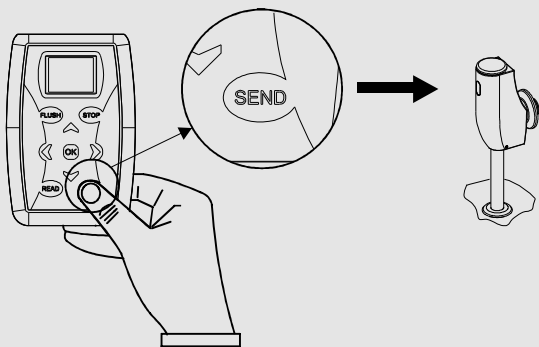

Reinigungsspülung

 AUS → EIN (12 Stunden – eingestellte Reinigungspülperiode)
 (1, 3, 6, 12, 24, 48, 72, 96, 108 (Stunden))

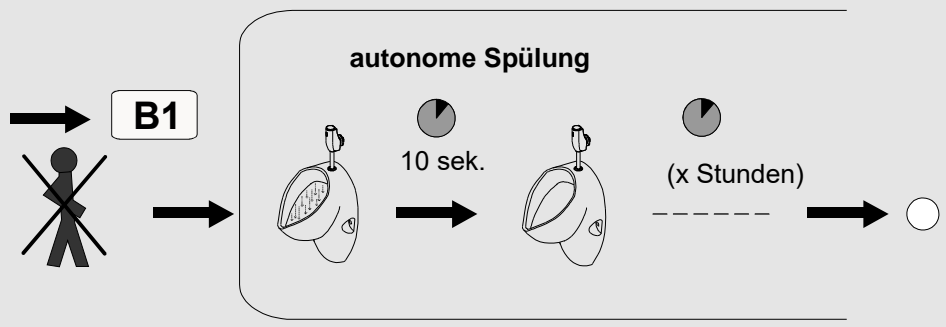
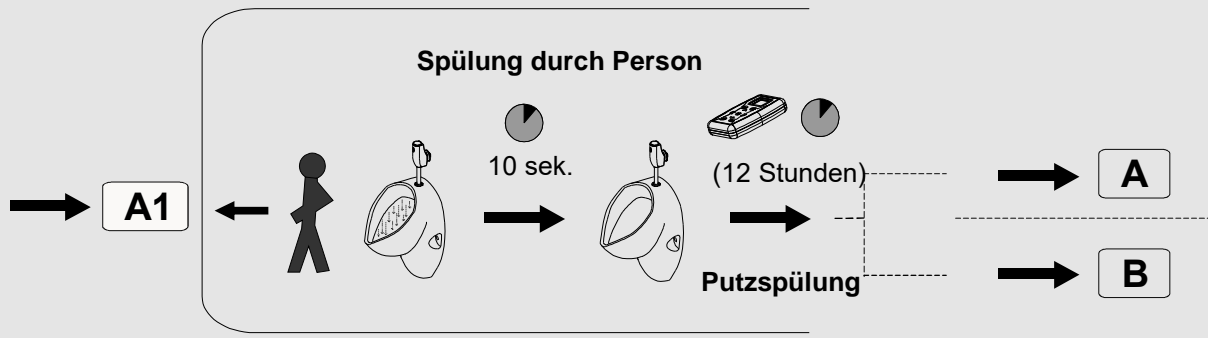
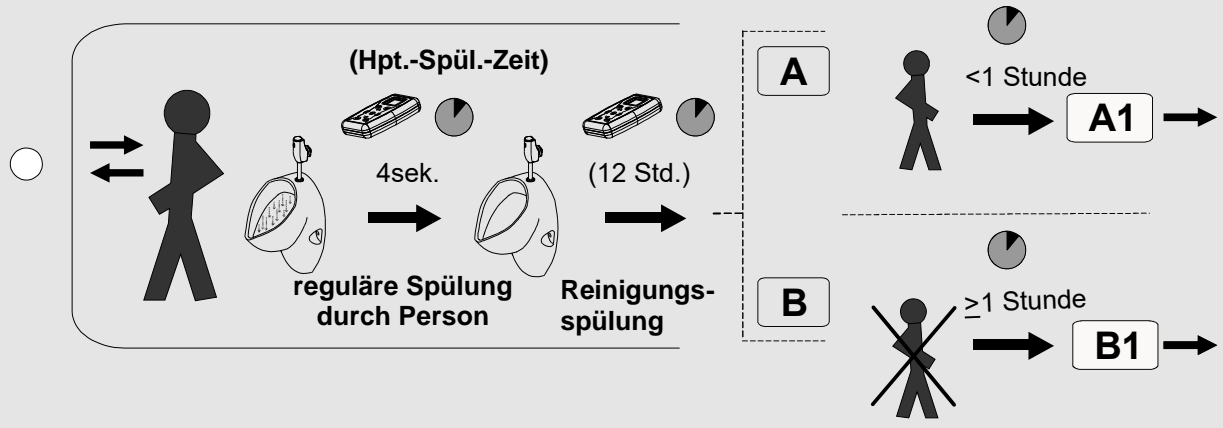

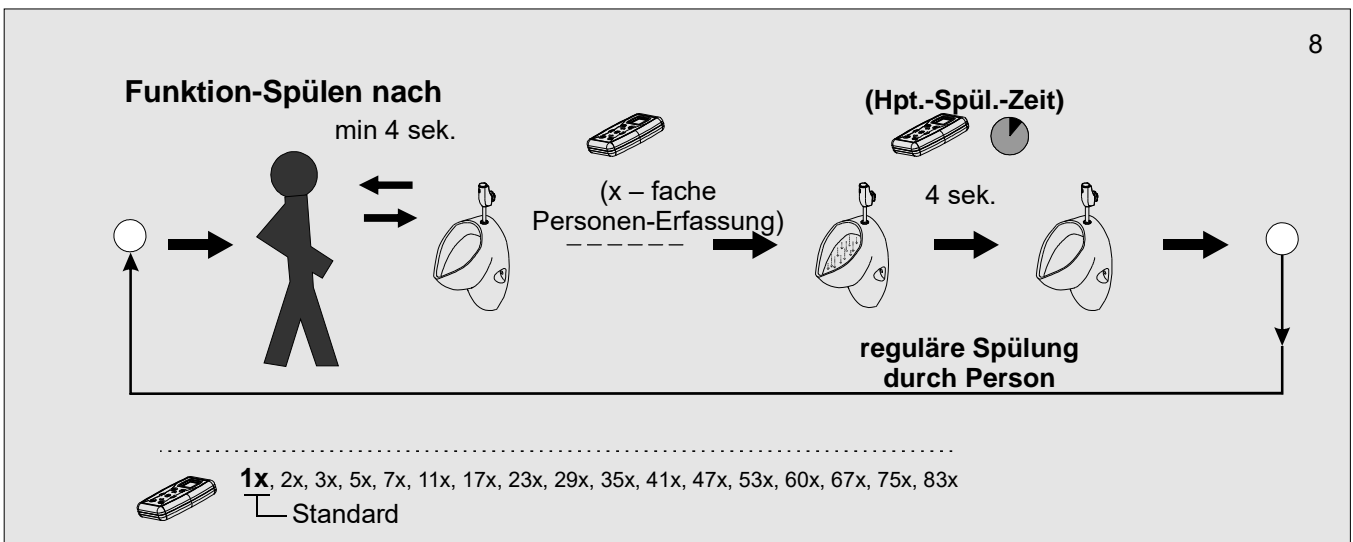
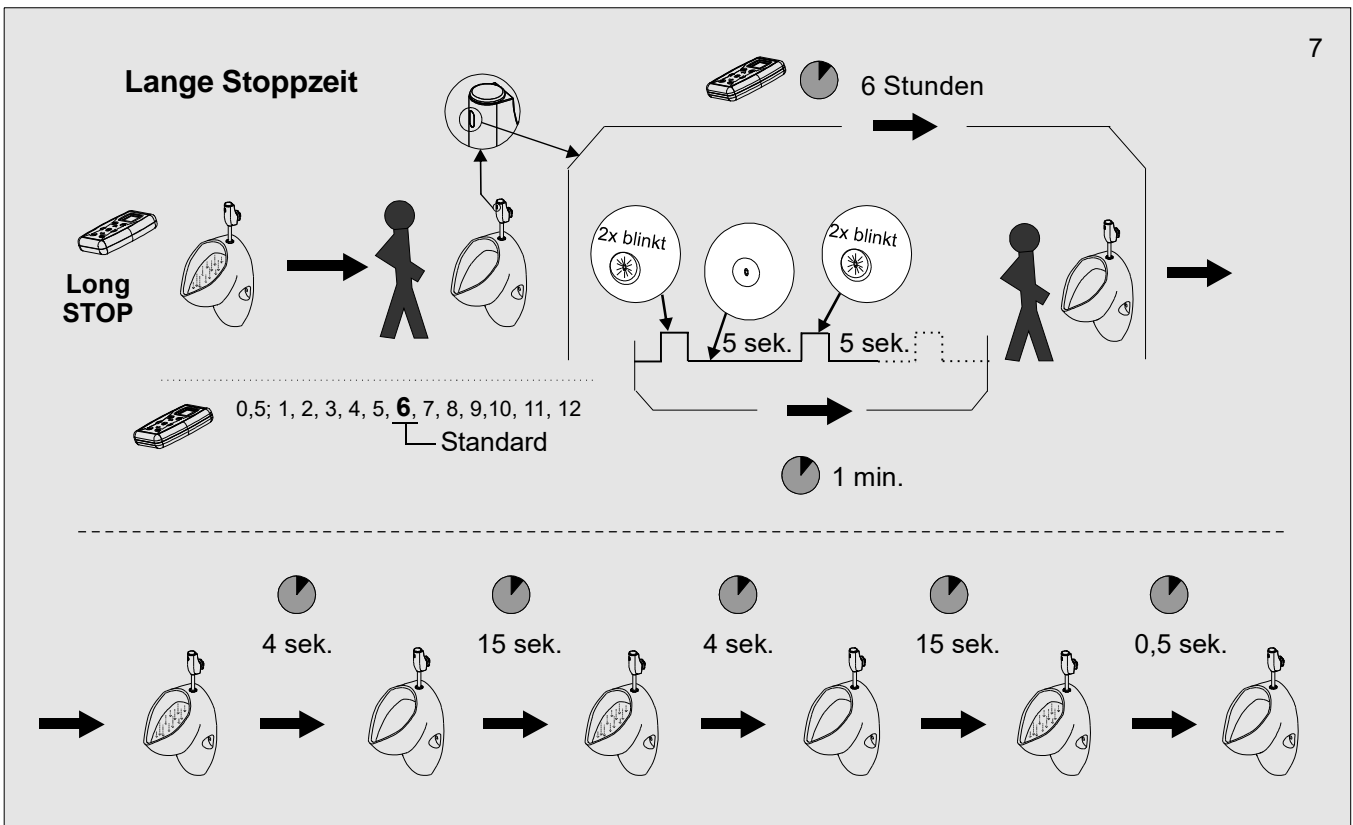
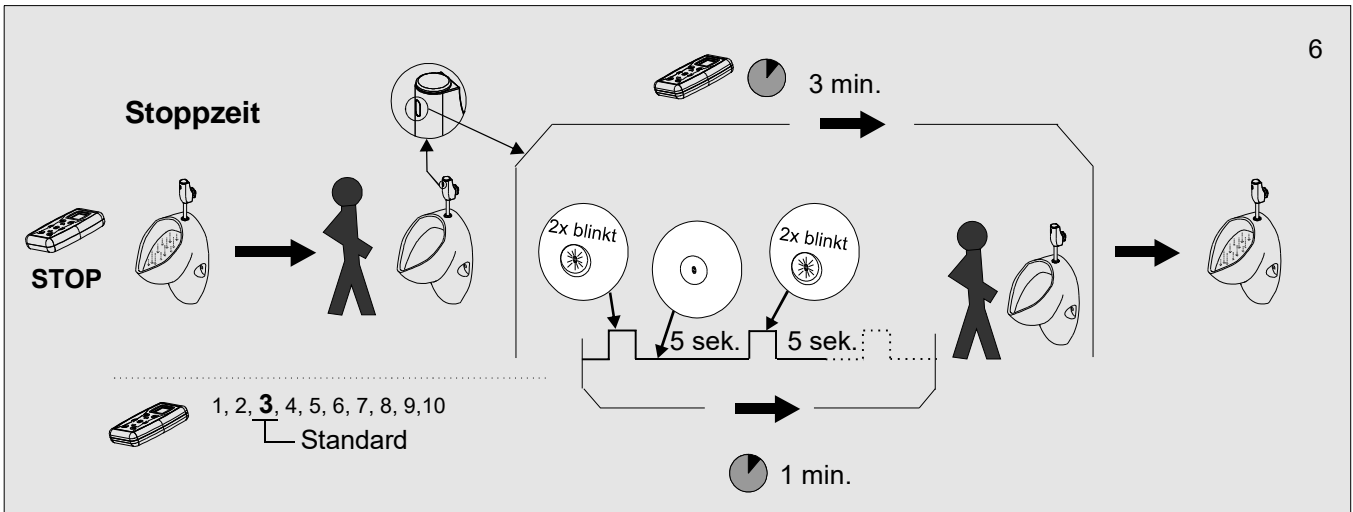

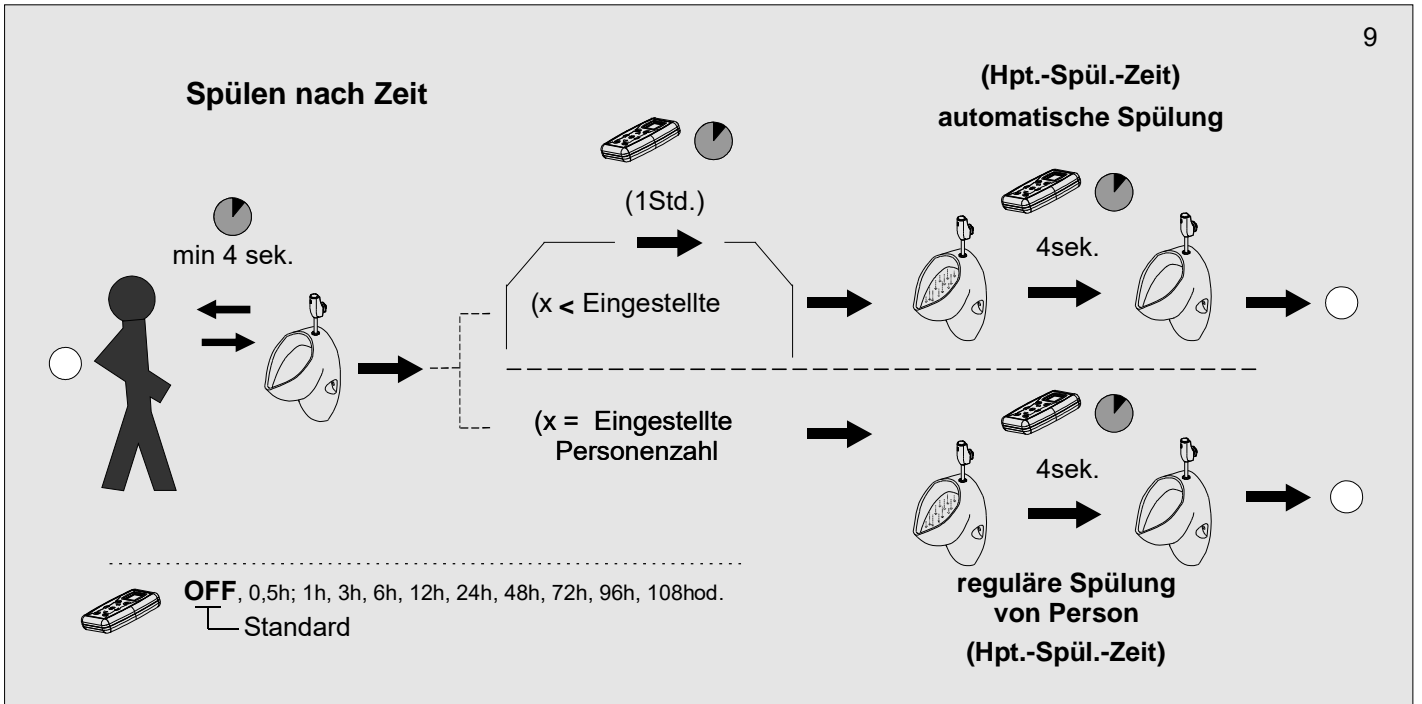

3. Grundmaße

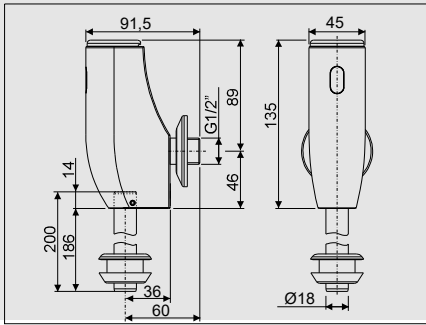

4. Bauvorbereitung

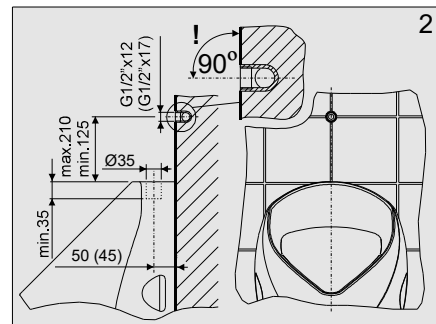
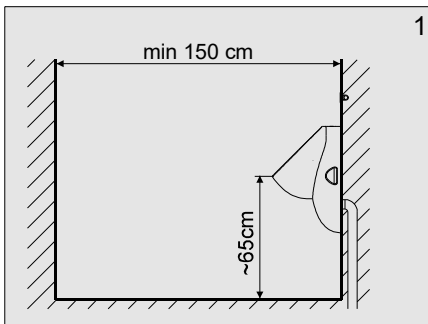

5. Installation

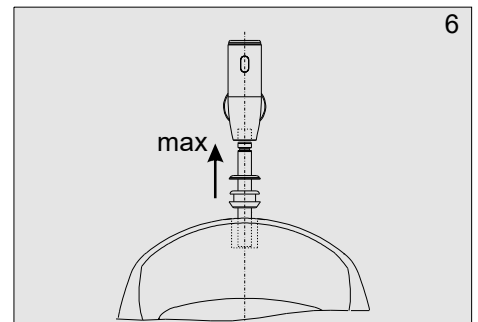
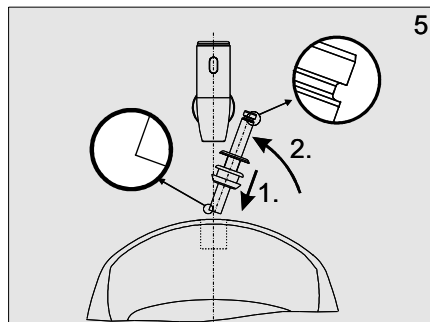
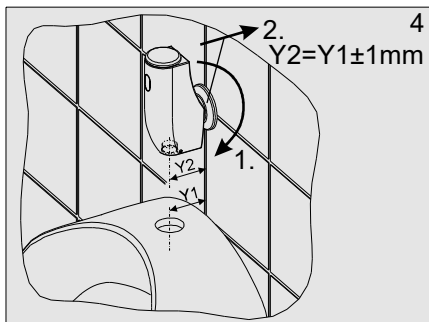
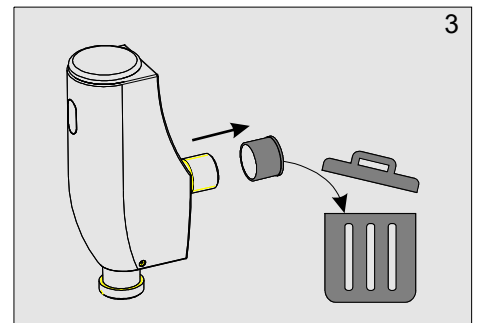
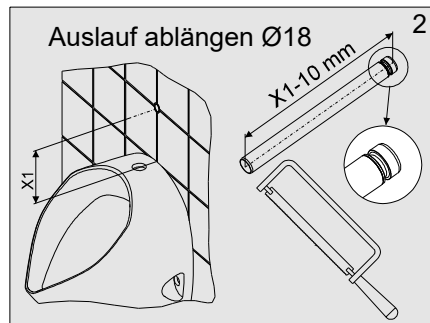
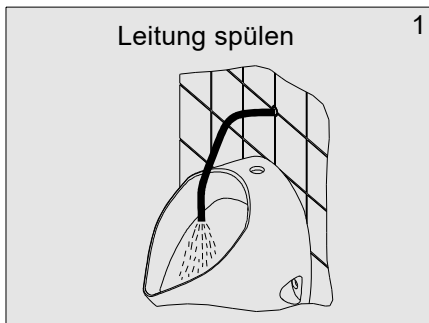

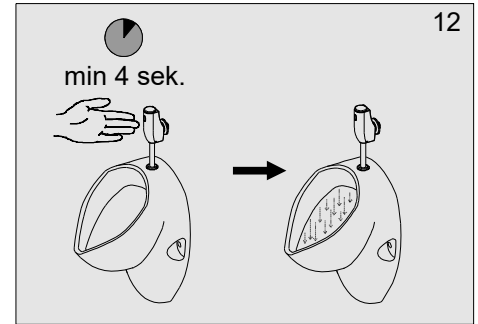
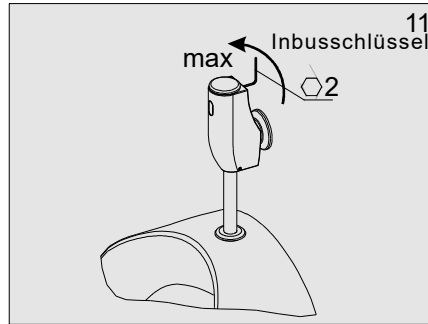
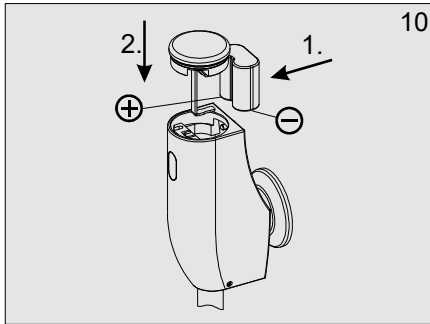
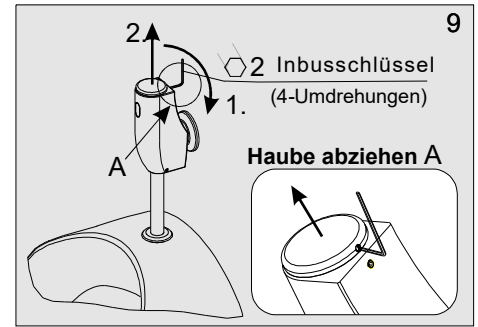
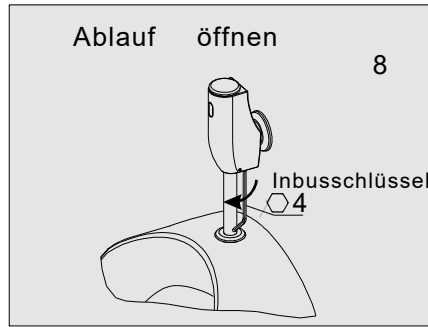
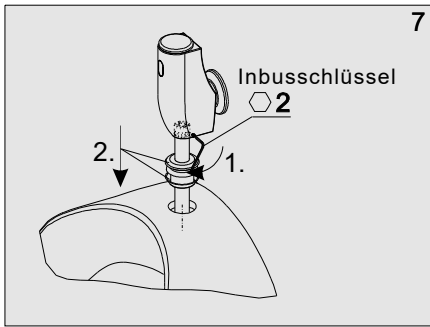

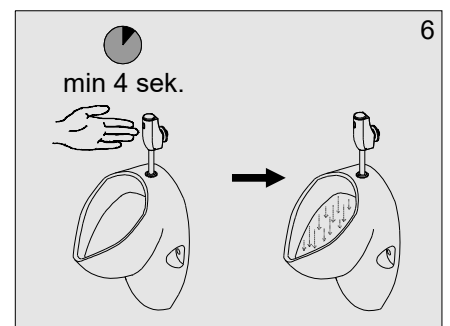
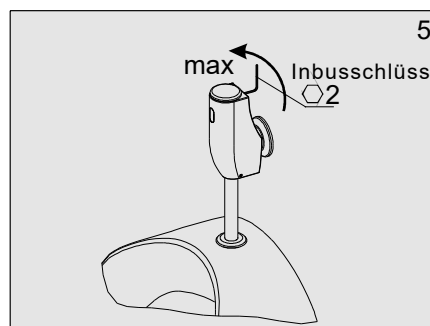
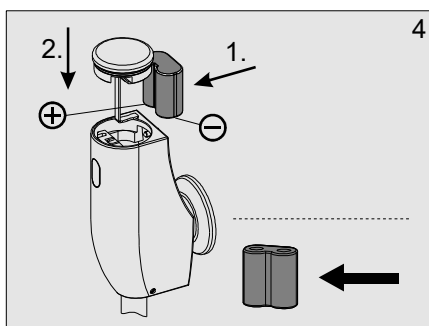
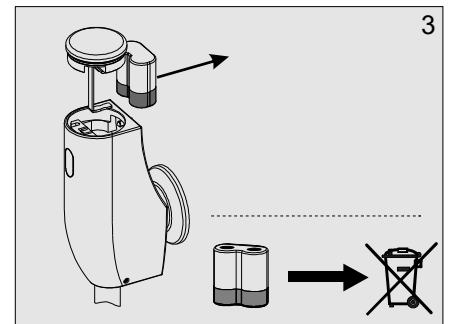
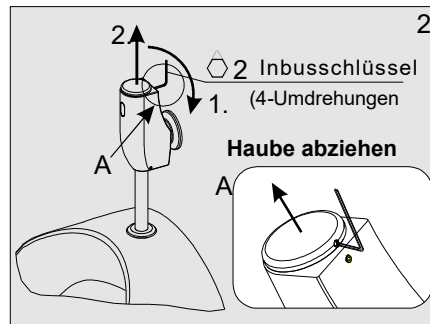
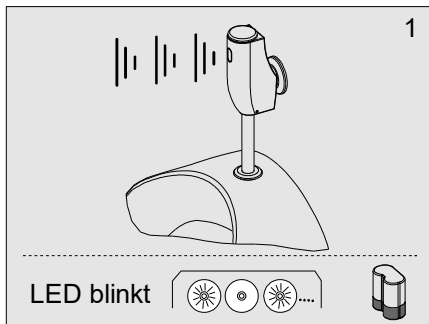

6. Batterie einlegen

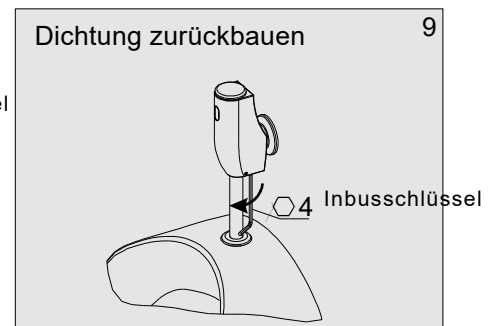
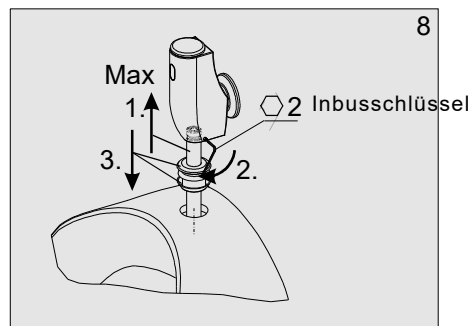
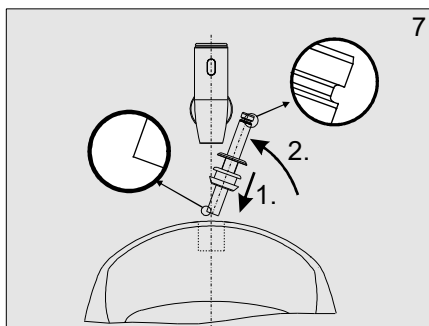
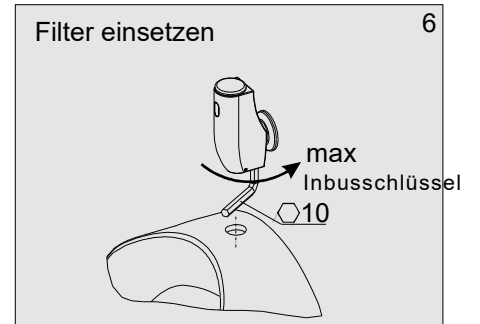
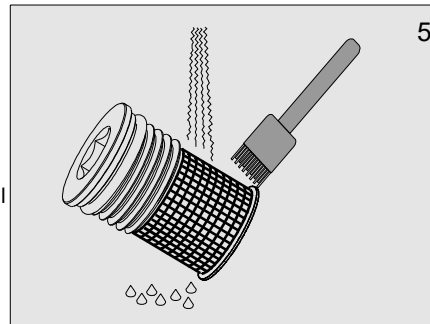
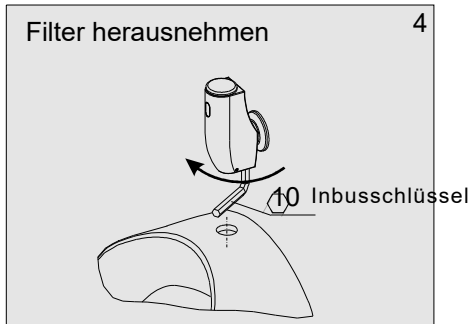
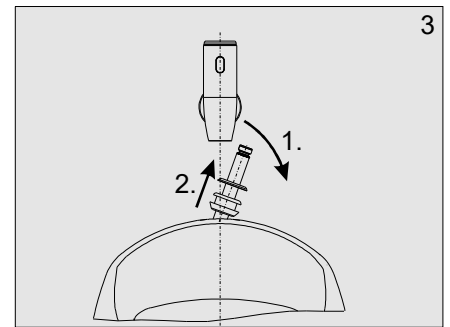
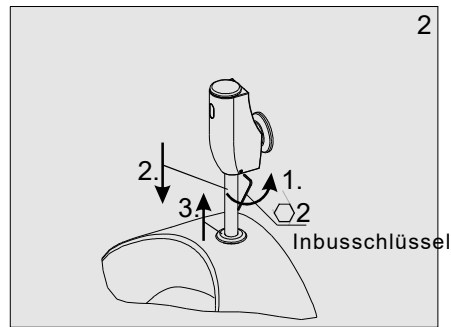
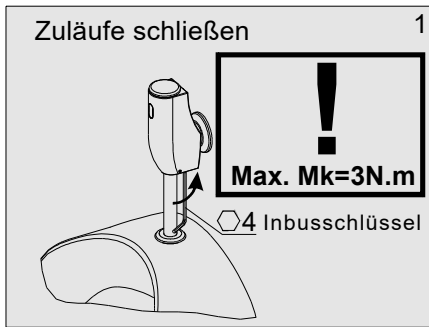

7. Filtersieb Reinigung



8. Problemlösungen

Problembeschreibung	Ursache	Behebung
Kein Wasserfluß	<ul style="list-style-type: none"> • Geschlossenes Zylinder-Ventil 	Zylinderventil öffnen
	<ul style="list-style-type: none"> • Keine Stromversorgung • Sensor funktionslos 	Service anrufen
LED-Diode blinkt 	<ul style="list-style-type: none"> • Batterie leer 	Batterie wechseln
Geringer Durchfluß	<ul style="list-style-type: none"> • Filtersiebe verstopft 	Filtersiebe reinigen
Dauerfluß	<ul style="list-style-type: none"> • keine Stromversorgung • Magnetventil defekt 	Str.-Versorg. prüfen Zylinderventil schließen und Service rufen

9. Wichtige Hinweise

Batteriefach, Batterie 6V und Netzteile sind nicht Produktbestandteil.

Keine mechanischen, alkoholhaltigen, amoniakhaltigen, säurehaltigen, schwefelhaltigen und chlorhaltigen Reinigungsmitteln verwenden.

%\$"9fgUmhY`]ghY

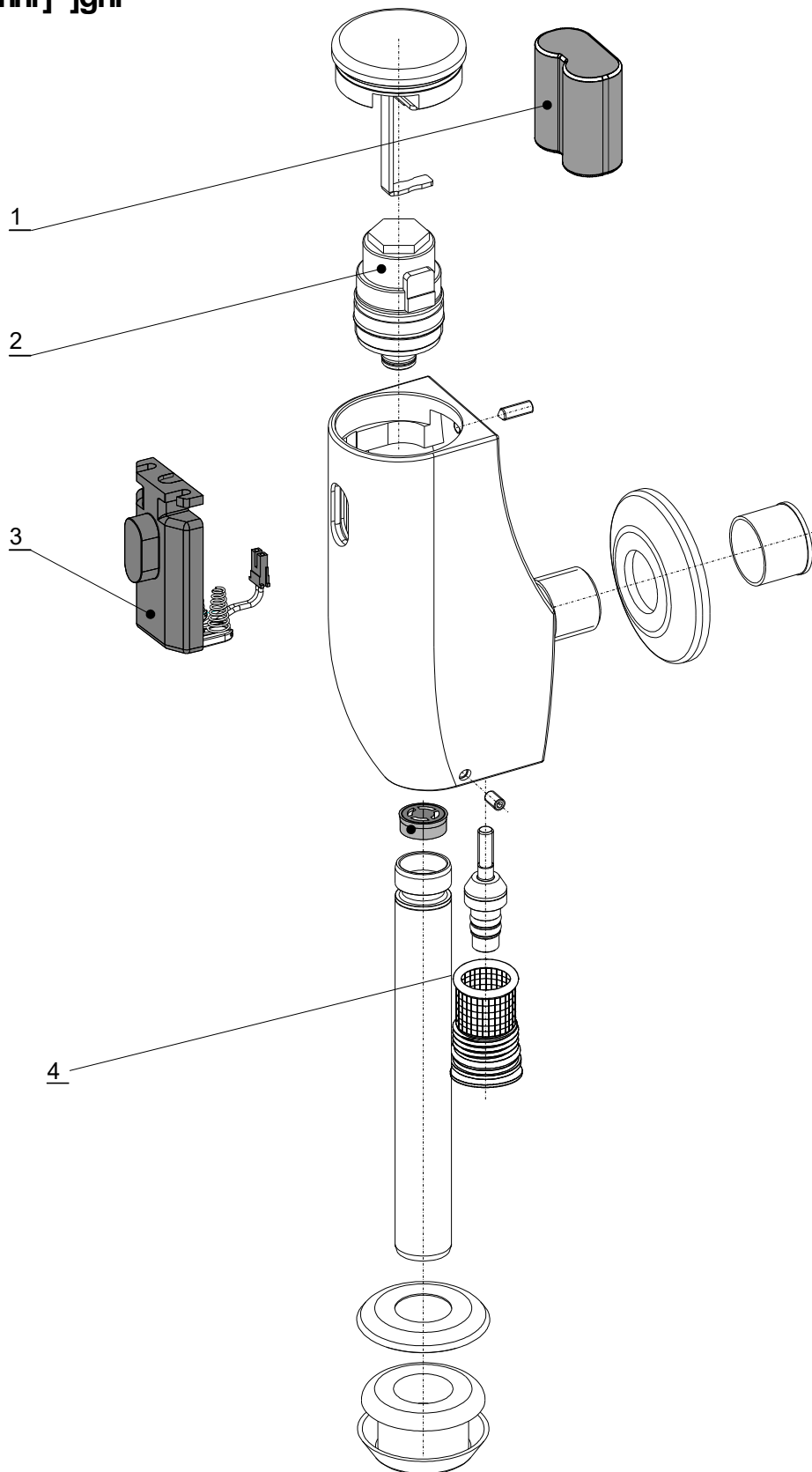

1. Art. 7.2230.00.00 Batterie
2. Art. 4.8940.07.25 Magnetventil
3. Art. 4.8940.05.30 Elektronik
4. Art. 4.8940.05.60 Filter